

100
0 10
A1

DO NOT SCALE

File: 5213957-ATK-01-ZZ-DR-ST-900803.dwg
Date: Nov 14, 2023 - 11:41am
Plotted by: ossullivan

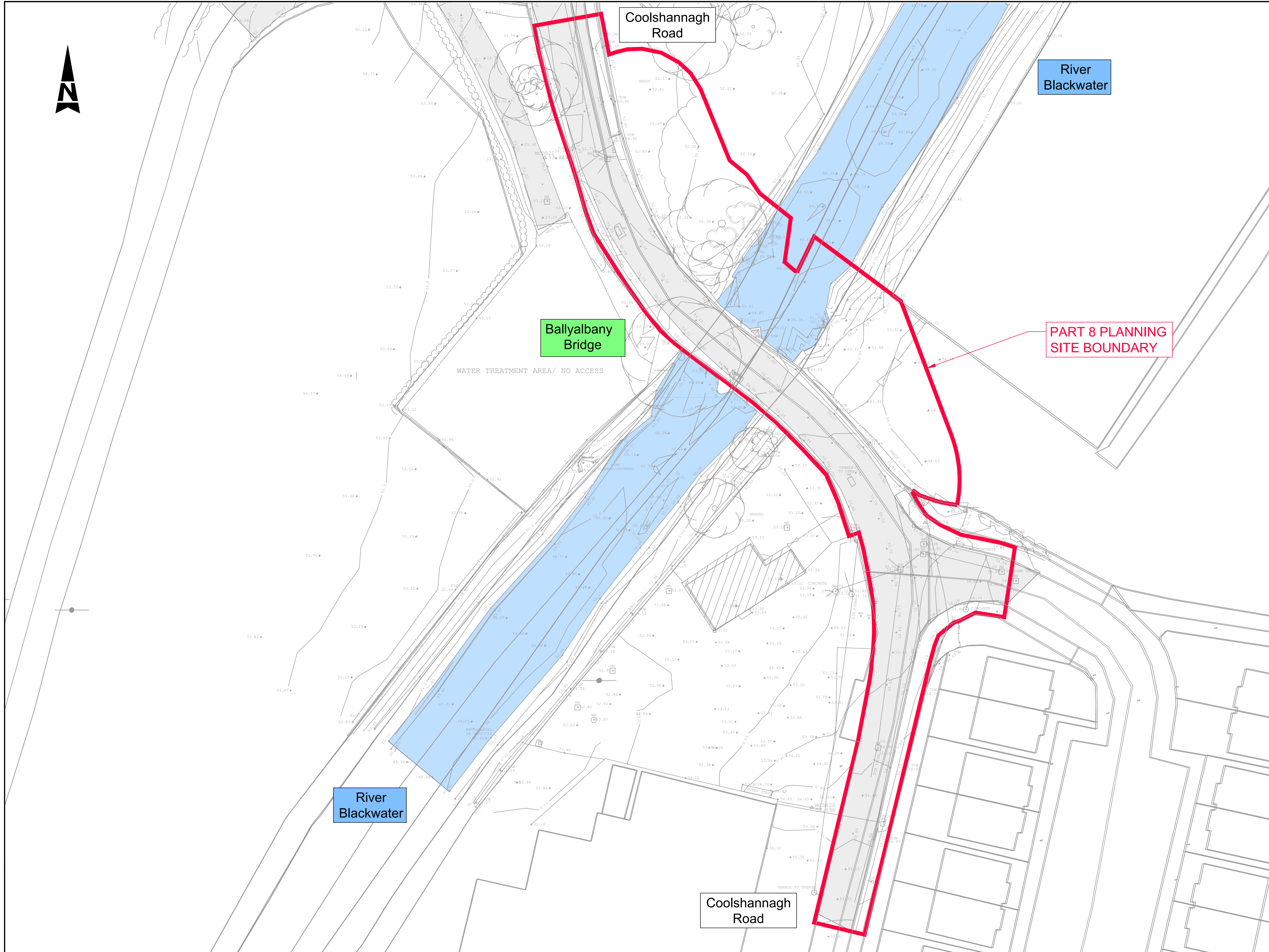

- GENERAL NOTES**
1. ALL DIMENSIONS ARE IN MILLIMETRES UNLESS NOTED OTHERWISE
 2. ONLY WRITTEN DIMENSIONS SHALL BE USED. NO DIMENSIONS SHALL BE SCALED FROM THE DRAWINGS
 3. ALL LEVELS ARE IN METRES AND ARE TO MALIN HEAD DATUM
 4. ALL COORDINATES ARE IN METRES AND ARE TO IRISH TRANSVERSE MERCATOR
 5. DRAWINGS ARE TO BE READ IN CONJUNCTION WITH THE SPECIFICATION

- ORDNANCE SURVEY MAPPING**
1. RASTER TILE REFERENCE OS2362-D
 2. VECTOR MAPPING TILE REFERENCE
1:2500 - 1036-D
1:1000 - 1036-20

Purpose		PART 8 PLANNING				
Title		BALLYALBANAY BRIDGE EXISTING SITE LAYOUT PLAN				
Original Scale	Drawn	Checked	Reviewed	Authorised		
1:250 at A1 1:500 at A3	AOS	GOH	RM	RM		
Date	Date	Date	Date	Date		
25.10.23	25.10.23	25.10.23	25.10.23	25.10.23		
Status	Drawing Number					
A2	5213957-ATK-01-ZZ-DR-ST-900803				P0	

© ORDNANCE SURVEY IRELAND LICENSE NR. AR 0082523. ORDNANCE SURVEY IRELAND & GOVERNMENT OF IRELAND
ATKINS WILL NOT TO BE HELD LIABLE FOR THE USE OF THIS DATA ON ANY PROJECT OTHER THAN ACTIVE TRAVEL INFRASTRUCTURE BALLYALBANAY & HORSESHOE BRIDGES



Comhairle Contae Mhuineacháin
Monaghan County Council

PO	ISSUED FOR PART 8 PLANNING	AOS	25.10.23	GOH	RM	RM
Rev	Description	By	Date	Chk'd	Rev'd	Auth



Member of the SNC-Lavalin Group

Atkins House, 150-155 Airside Business Park, Swords, Co. Dublin
Tel (+353) 01 810 8000
Fax (+353) 01 810 8001

Unit 2B, 2200 Cork Airport Business Park, Cork
Tel (+353) 021 429 0300
Fax (+353) 021 429 0360

1st Floor Technology House Parkmore Technology Park, Galway
Tel (+353) 091 786 050
Fax (+353) 091 779 830

Client
MONAGHAN COUNTY COUNCIL

Project
**ACTIVE TRAVEL INFRASTRUCTURE
BALLYALBANAY & HORSESHOE
BRIDGES**