

A1

DO NOT SCALE

File: 5213957-ATK-02-ZZ-DR-ST-900814 to 0815.dwg
Date: Nov 14, 2023 - 10:33am
Plotted by: ossullivan

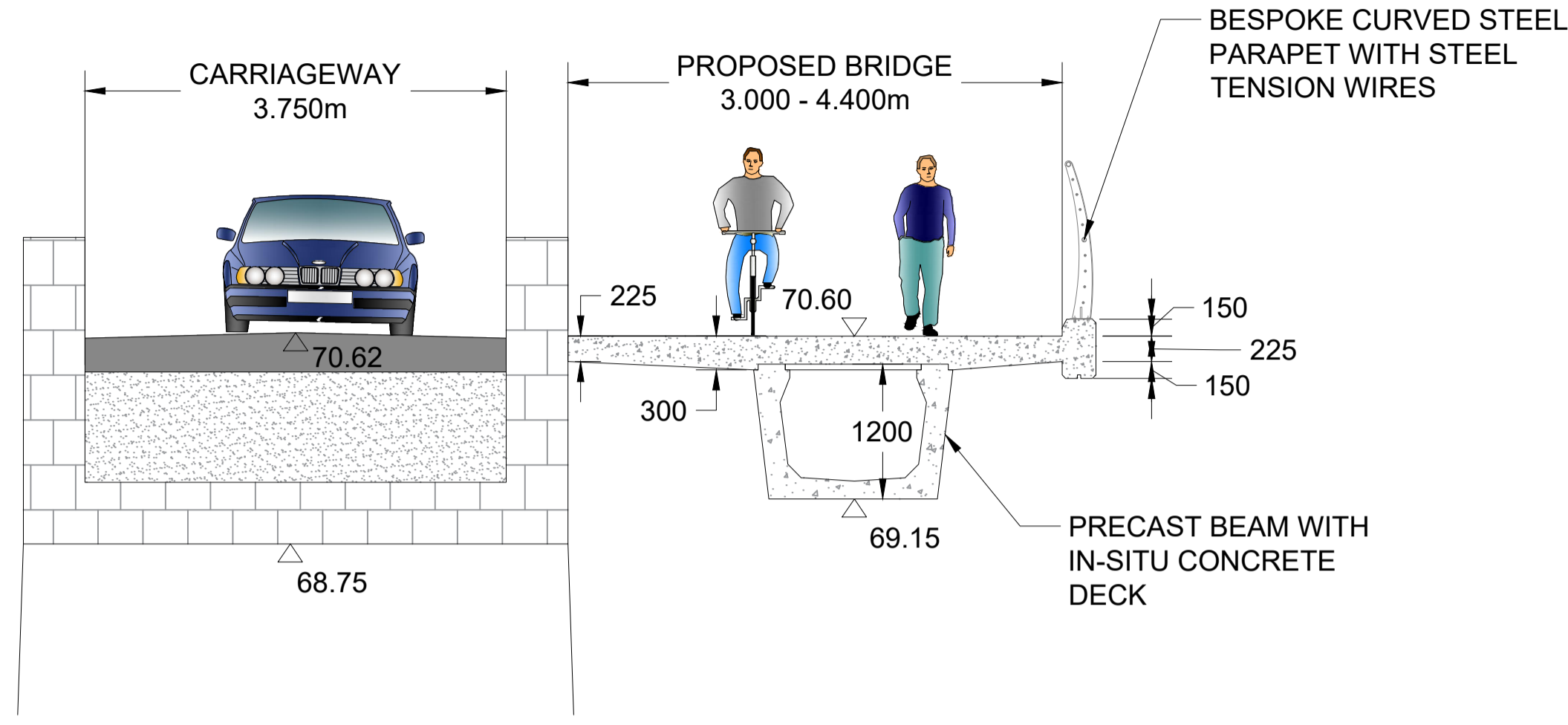

TYPICAL CROSS SECTION

Scale at A1 1:50
Scale at A3 1:100

- GENERAL NOTES
1. ALL DIMENSIONS ARE IN MILLIMETRES UNLESS NOTED OTHERWISE
 2. ONLY WRITTEN DIMENSIONS SHALL BE USED. NO DIMENSIONS SHALL BE SCALED FROM THE DRAWINGS
 3. ALL LEVELS ARE IN METRES AND ARE TO MALIN HEAD DATUM
 4. ALL COORDINATES ARE IN METRES AND ARE TO IRISH TRANSVERSE MERCATOR
 5. DRAWINGS ARE TO BE READ IN CONJUNCTION WITH THE SPECIFICATION

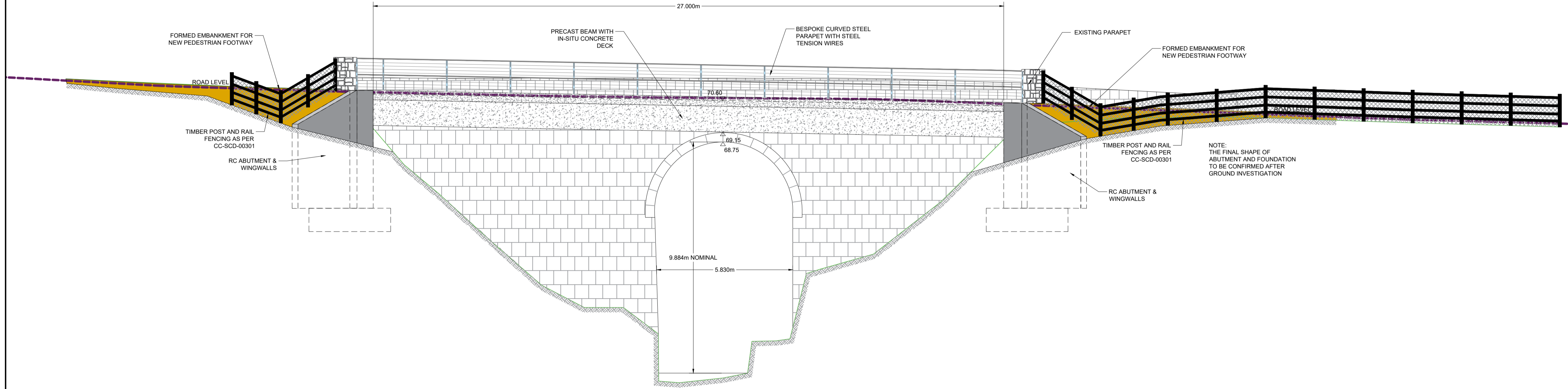

PROPOSED WORKS - SOUTH WESTERN ELEVATION

Scale at A1 1:100
Scale at A3 1:200

© ORDNANCE SURVEY IRELAND LICENSE NR. AR 0082523. ORDNANCE SURVEY IRELAND & GOVERNMENT OF IRELAND

ATKINS WILL NOT BE HELD LIABLE FOR THE USE OF THIS DATA ON ANY PROJECT OTHER THAN ACTIVE TRAVEL INFRASTRUCTURE BALLYALBANEY & HORSESHOE BRIDGES



Comhairle Contae Mhuineacháin
Monaghan County Council

Risk Level	X	Atkins Base Line - Low Risk
		Atkins Sensitive - Medium Risk
		Atkins Private - High Risk
		Client Critical - Already Marked

PO	ISSUED FOR PART 8 PLANNING	AOS	25.10.23	GOH	RM	RM
Rev	Description	By	Date	Chk'd	Rev'd	Auth

ATKINS
Member of the SNC-Lavalin Group

Atkins House, 150-155 Ainslie Business Park, Swords, Co. Dublin
Tel (+353) 01 810 8000
Fax (+353) 01 810 8001

Unit 2B, 2200 Cork Airport Business Park, Cork
Tel (+353) 021 429 0300
Fax (+353) 021 429 0360

1st Floor Technology House Parkmore Technology Park, Galway
Tel (+353) 091 786 050
Fax (+353) 091 779 830

Client: MONAGHAN COUNTY COUNCIL

Project: ACTIVE TRAVEL INFRASTRUCTURE BALLYALBANEY & HORSESHOE BRIDGES

Purpose		PART 8 PLANNING			
Title		HORSESHOE BRIDGE PROPOSED CROSS SECTION AND ELEVATION			
Original Scale	As Shown	Drawn	Checked	Reviewed	Authorised
		AOS	GOH	RM	RM
Date	Date	Date	Date	Date	Date
25.10.23	25.10.23	25.10.23	25.10.23	25.10.23	25.10.23
Status	Drawing Number	Rev		Rev	
A2	5213957-ATK-01-ZZ-DR-ST-900815	P0		P0	