

REVISION SCHEDULE					
REV. NO.	REV. DESCRIPTION	REV. DATE	DRAWN	CHECKED	
PL1	ISSUED FOR PRE-PLANNING DISCUSSION	16/08/2023	JPC	JFC	
PL2	ISSUED FOR PRE-PLANNING DISCUSSION	31/08/2023	JPC	JFC	
PL3	ISSUED FOR PLANNING	23/11/2023	KJD	JFC	

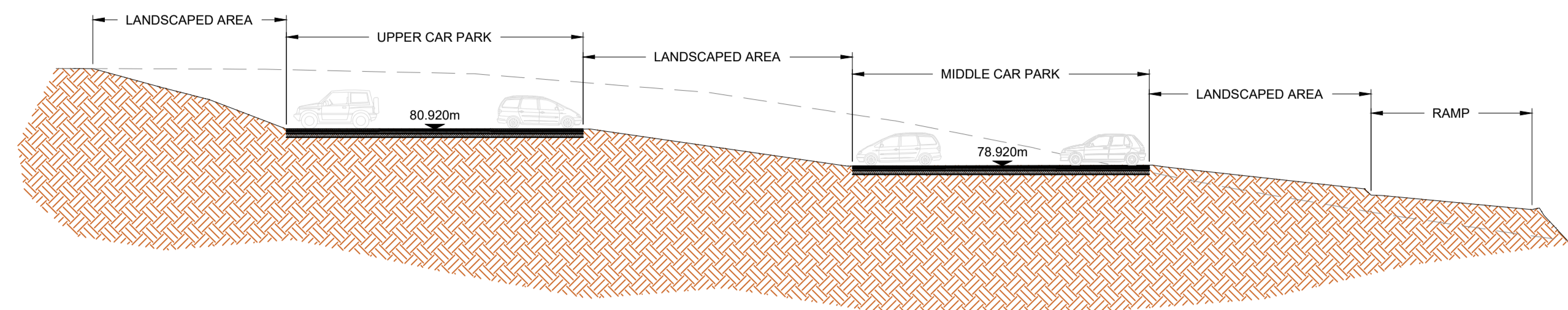

1 SITE SECTION 1-1  
SCALE 1:250

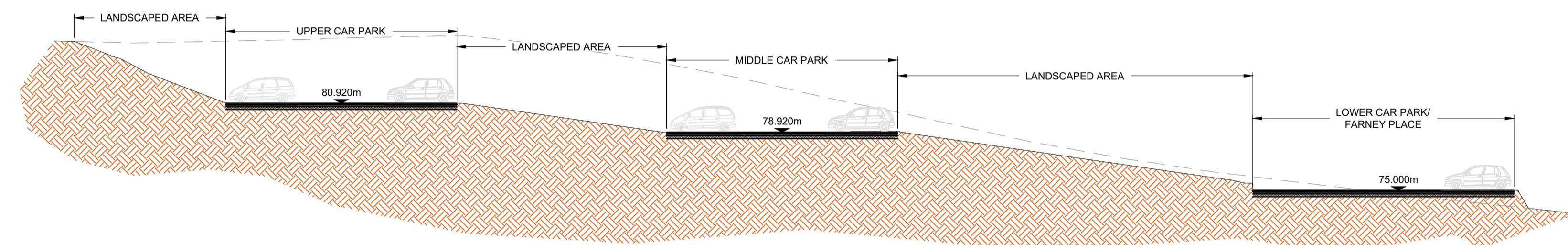

2 SITE SECTION 2-2  
SCALE 1:250

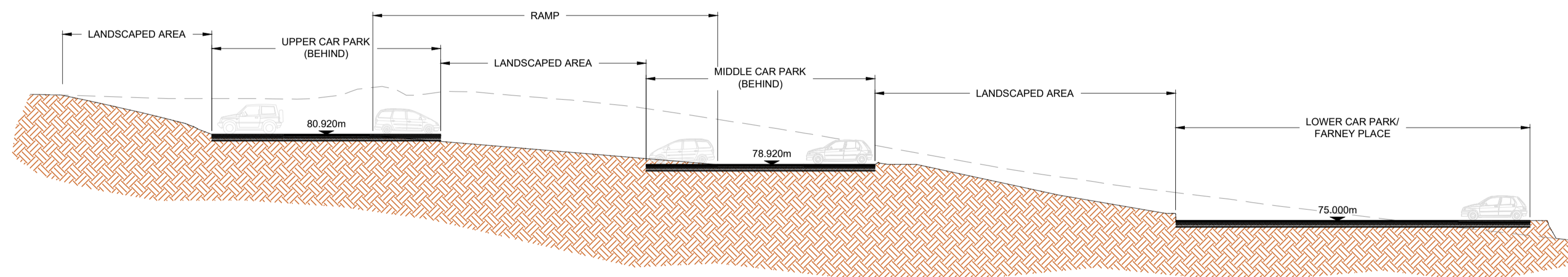

3 SITE SECTION 3-3  
SCALE 1:250

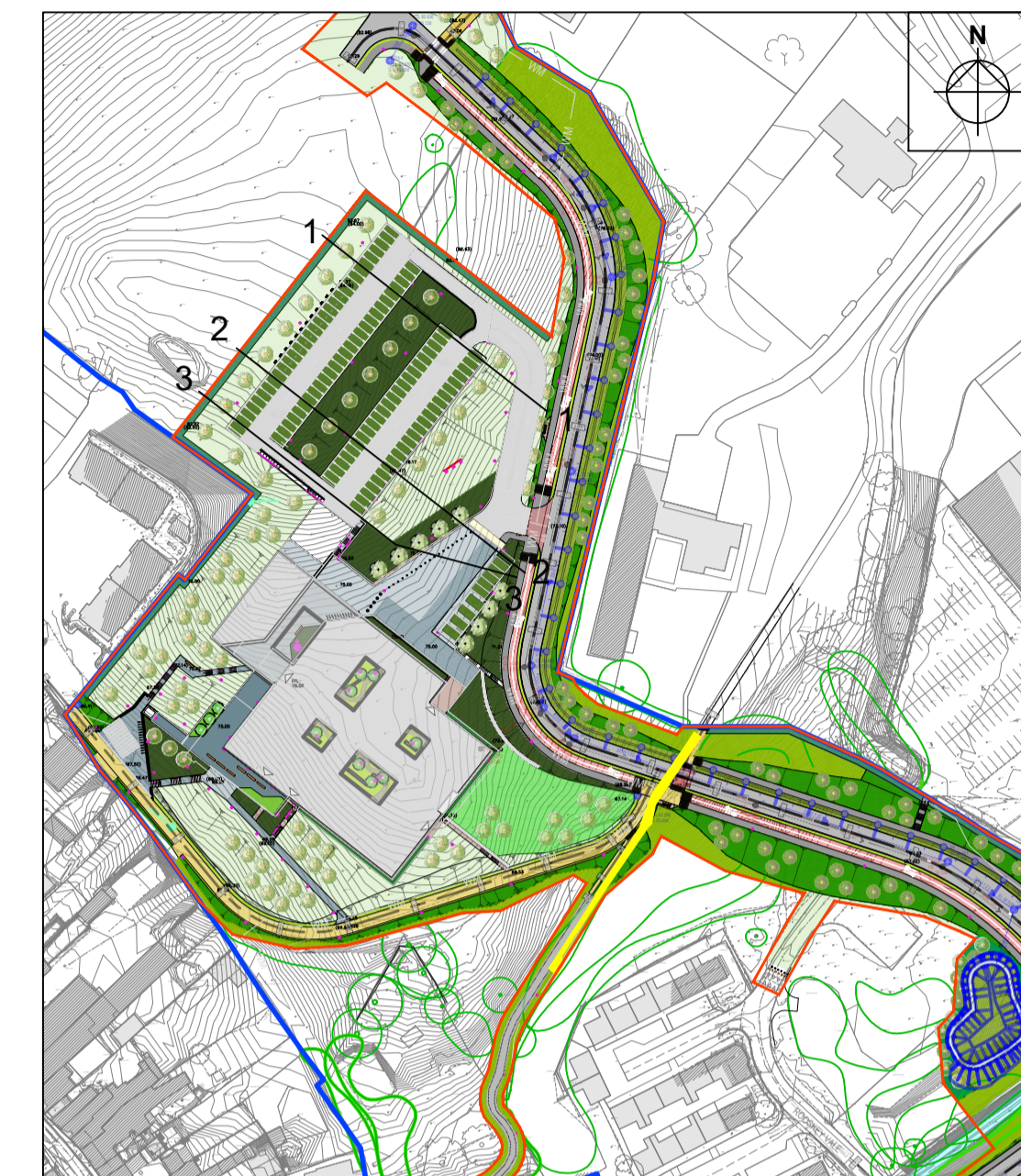

5 KEY PLAN  
SCALE 1:2000

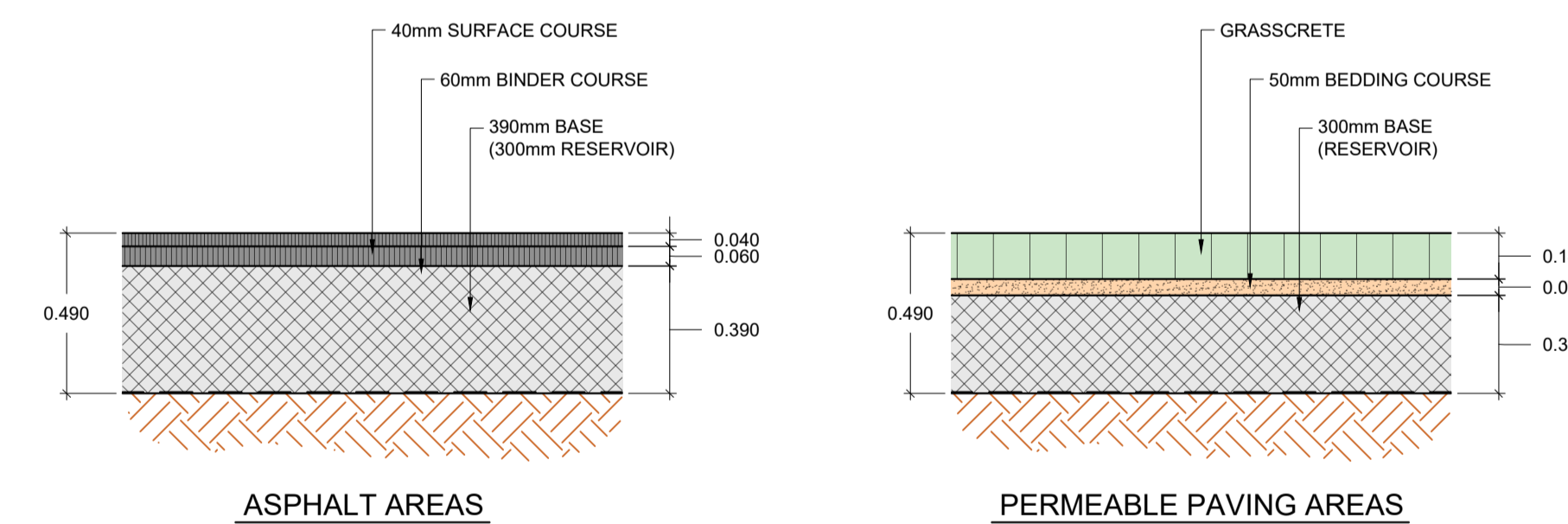

ASPHALT AREAS IN CIRCULATION AREAS

PERMEABLE PAVING AREAS IN SPACES

4 TYPICAL SECTION THRU' CAR PARK CIRCULATION/PARKING SPACES  
SCALE 1:20

Drawing Stage:  <b>PLANNING</b>	Project Details:	Notes	Drawn by:	Checked by:	Approved by:	Date:		Behan House, 10 Lower Mount Street, Dublin 2. D02 HT71 Tel: +353 1 661 1100 e-mail: info@cora.ie Web: www.cora.ie																
	Site Address:		MONAGHAN CO. CO. HQ, ROOSKY, MONAGHAN TOWN	JPC	KO'M	JFC		FEB '23																
	Client:		MONAGHAN COUNTY COUNCIL	Project Name:	CIVIC OFFICES	Scale:		A.S. @ A1	Project Number:	2223														
	Architect:		HENRY J LYONS ARCHITECTS	Drawing Title:	SITE SECTIONS - SHEET 1	Project:		MCC	Originator:	CORA	Zone:	ZZ	Level:	ZZ	Type:	DR	Discipline:	C	Drawing No:	1001	Stage:		Revision:	PL3
	M&E Designer:																							
Contractor:																								