

ALL DIMENSIONS TO BE CHECKED ON SITE  
NO DIMENSIONS TO BE SCALED FROM THIS DRAWING  
DRAWING IS TO BE READ IN CONJUNCTION WITH RELEVANT CONSULTANTS DRAWINGS

Note: Survey by Apex Surveys, July 2022  
Datum: Malin Head (OSMG15)  
OS License: 2023/OSI\_NMA\_158 Monaghan County Council

**KEY:**

- Site boundary subject to planning application
- Lands within Applicant's Ownership
- Right of Way
- Approximate Location of Site Notice

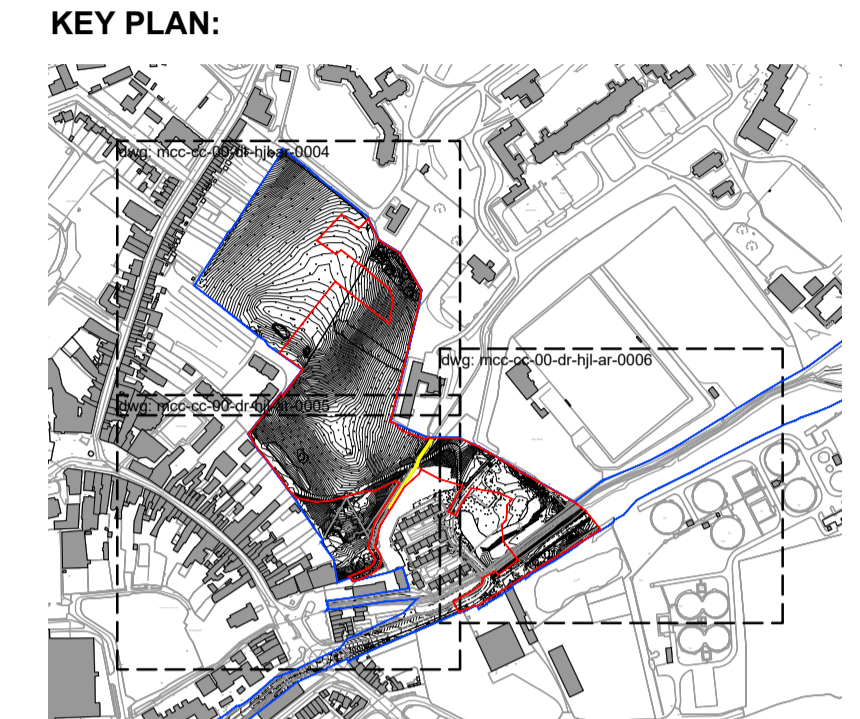

**OS LICENSE:**  
2023/OSI\_NMA\_158 Monaghan County Council  
Ordnance Survey Ireland/Government of Ireland  
Licensed under Monaghan County Council Accession Burs

**CLIP EXTENT:**  
LLX.LLY = 66937.82595  
URX.LRY = 66938.82595  
ULX.LLY = 66937.82595  
URX.LRY = 66938.82595

**PROJECTION:**  
ITM

**ITM CENTRE POINT CO-ORDINATE:**  
X Y = 667936.634155

Copyright:  
© Surbhareacht Ordánas Éireann, 2023  
© Ordnance Survey Ireland, 2023

Copyright:  
© Surbhareacht Ordánas Éireann, 2023  
© Ordnance Survey Ireland, 2023

Ánaíocht agus ánaíocht ag Surbhareacht Ordánas Éireann. Pláin in Fhionnasa. Bain Ánaíocht & Éire.  
Compiled and published by Ordnance Survey Ireland, Phoenix Park, Dublin 8, Ireland.  
Sealán ábairtáil inéireadairle cúlchruinn Surbhareacht Ordánas Éireann agus Rialtas na hÉireann.

Unauthorised reproduction infringes Ordnance Survey Ireland and Government of Ireland copyright.  
Gach ceard ar coisrinn. Ní ceadmhach an chuid den fhóilseáil seo a chlopbáil, a ábairtáil nó a fíorú in aon form nó ar aon bhealach gan cead a scríobhann roimh ré ó údar an chlopbáil.

All rights reserved. No part of this publication may be copied, reproduced or transmitted in any form or by any means without the prior written permission of the copyright owner.  
Ní hionann bithar, bealach nó cosán a thabairt ar an ábairtáil seo agus fionnasa ar chuid í.  
The representation on this map of a road, track or path is not evidence of the existence of a right of way.  
Ní thaispeánann léaráil de chuid Ordánas Shurbhreachaí na hÉireann teorann phriontáil de mhéid an ánaíochta de ghráinne fíricí.

Ordnance Survey maps never show legal property boundaries, nor do they show ownership of physical features.  
NOTE: Project boundary and location are set on OGI baseline mapping and provided for reference only. The map details are only accurate to the resolution at which they were captured. Output scale is not indicative of data capture scale. Measurements should not be taken directly from this drawing. For exact measurements, please refer to the site layout map.

REV	DATE	DESCRIPTION	CKH	DRN
P1	17/11/2023	ISSUED FOR PLANNING	SA	RC

STATUS CODE DESCRIPTION

**STATUTORY SUBMISSION - PLANNING PERMISSION**

CLIENT  
**MONAGHAN COUNTY COUNCIL**

PROJECT  
**CIVIC OFFICES**

DRAWING  
**EXISTING SITE PLAN (1 OF 3)**

PROJECT NUMBER  
95-1026

DATE  
28/06/2023

SCALE@ A1:  
1:500

DRAWN/CHECKED:  
SASA

STATUS CODE: DRAWING NUMBER REVISION  
P3 MCC-XX-00-DR-HJL-AR-0004 - P1

**Henry J Lyons**

Architecture • Interiors  
henrylyons.com

+353 1 888 3333  
info@henrylyons.com

51-54 Pearse Street  
Dublin D02 KA66

Refer to Draw MCC-XX-00-DR-HJL-AR-0005

Refer to Draw MCC-XX-00-DR-HJL-AR-0006